

Choosing The Right Tires For Your Application Cost Control Basics

Why is Tire Selection Important?

Have you experienced unplanned downtime due to maintenance or safety issues? Are you looking for a way to improve production? Believe it or not, there is a "right tire" for each specific application. Consider the effects of improper tire usage to your operation. Operating a forklift truck with improper tires can unsafely reduce its lifting capacity and stability. Additionally, improper tire usage can cause undue stress to major components, which increase maintenance and fuel costs while lowering production levels. Therefore, to ensure maximum forklift truck performance, tire selection is vital. As a total solutions provider, Mitsubishi Forklift Trucks and Promatch® provide your Mitsubishi forklift truck dealer with a selection of high quality tires and will help you choose the proper type for your application.

Factors to Consider When Choosing Tires

- 1 **Fuel and Power Consumption.** Operating with tires that use less energy and have lower rolling resistance could reduce fuel consumption by as much as 10% and lower maintenance costs. Using the proper tires for the job can also extend the life of industrial batteries and increase daily production levels..
- 2 **Safety.** Selecting the right tire for the job can significantly increase operator safety. Conversely, operating with worn or chunked tires puts the forklift truck's stability and carrying capacity at risk.
- 3 **Product Protection.** Because the only parts of a forklift truck that touch the ground are the tires, it is important to consider the role tires play in protecting your product. Some tires offer more shock absorption for protection while handling the load.
- 4 **Shock and Operator Fatigue.** Did you know that the rubber on the tires is the only shock absorbing system on a forklift? truck Faulty or poor performing tires can greatly increase operator fatigue. This often results in lower productivity and potential safety issues as weariness hinders an operator's awareness and reaction time.
- 5 **Operating Conditions.** Forklift truck tires are designed to match the specific need of the customer. Press-On tires come in different compounds that provide better cushioning for operator comfort and load stability with attachments. Alternative tread designs promote improved operation in littered, wet, oily or abusive applications. Solid tires offer a soft ride to prevent damage while eliminating flats, blow outs and associated down time.

Examples

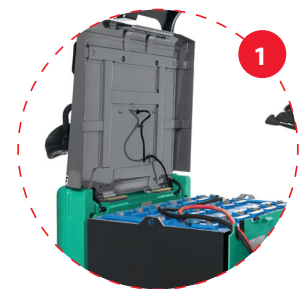

Choosing The Right Tires For Your Application

Cost Control Basics

The Promatch Parts Distribution Center provides your Mitsubishi forklift truck dealer with quality tires and other replacement parts that deliver long, trouble-free service. Use the following chart to select the right tire for your application, and contact your local Mitsubishi forklift truck dealer for further details and assistance to meet your specific needs.

Application Type	Press On Tires	Resilient-Pneumatic Tires
Solutions		
Oil, Acid, Fats, Alkaline	OR Smooth, Traction or Wide Track	SFT, V, PC Smooth - T800
Highly Flammable/Explosive Conditions	SC Smooth, Traction, Grooved or Wide Track	—
Unpaved Yard	UN Smooth, Traction or Wide Track	V, PC Traction - T900
Fragile Loads	MCF Smooth or Wide Track	V, PC Traction - T900
High Temperature	MCF, OR Smooth Traction, Grooved or Wide Track	V, PC Traction - T900
Abrasive or Littered Floors	SRT, KRT Smooth, Traction or Wide Track	V, PC Traction - T900
Wet or Steel Ramps	SRT, KRT Smooth or Wide Track	V, PC Traction - T900
Narrow Aisle (Maximum Stability)	POLY Smooth	—
Electric Powered Equipment	MCF Smooth, Traction or Wide Track	—
Overload, High Abrasion, Fast Wear	SRT, KRT Smooth, Traction or Wide Track	V, PC Traction - T900
Clean Maintained Surfaces	MCF, NM Smooth or Traction	—
High Torque Conditions	—	V, PC Traction - T800
Normal Surfaces and Conditions	MCF Smooth or Traction	SFT, V, PC - T800

Press On Tires

MCF Multi-Class Formula	SRT Steel Reinforced
UN Universal	KRT Fiber Reinforced
EL Electric	OR Oil Resistant
NM Non-Marking	SC Static
POLY Polyurethane	

Resilient Pneumatic

SFT Soft Classic	T800
V Class V	T900
PC Premium Class	

